

7UHQFK 026 %DUULHU 6FKRWWN\ 5H

763 6 63

72

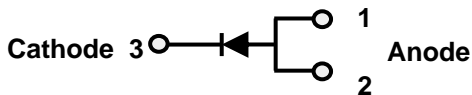

**Features**

- ‡ \$GYDQWUHQFK WHFKQRORJ\
- ‡ /RZRUZDURGDWDJH GURS
- ‡ /RZRZURVVHV
- ‡ +LJKILFLHQF\ RSHUDWLRO
- ‡ /HDGHHLQLVK &RPSOLDQW

**Applications**

- ‡ '&' &RQYHUWHUV
- ‡ \$&'&GDSWRUV
- ‡ 6ZLWFKRZHXSSOLHV
- ‡ )UHHZKHHLRGRJ

**Maximum ratings and electrical characteristics (TJ = 25°C unless otherwise noted)**

3DUDPHWHU	6\PERO	/LPLW	8QLW
0D[LPHSHVSHUNYHYURQHW DJH	9550		9
0D[LPHYHURJHZDUG UFXEWHIQWG	,) \$9		\$
3HDN IRVZDURSUHQW VLQRDQZDYH VXSHULPSURVHURSHGLRGH	,) 60	0	\$
2SHUDMXQRDQWRUDJH WDESHUDW XUH767*		WR	f&
7\SLFDO WKHUPDO UHVLVWDQFH SHU	GLSRGH ORXQWHG RQ )5		3&f% :
,QVWDQWDQHRXVWRUJZDUG SHGLRGH	9)	7<3	0\$;
		,) \$	7- f&
		,) \$	7- f&
		,) \$	7- f&

1RWHV

3XOVH WHVSHXOVH ZLGWK GXW\F\FOH

3XOVH WHVW 3XOVH ZLGWK 0

---

**RATINGS AND CHARACTERISTICS CURVES (TA = 25 °C unless otherwise noted)**

**PACKAGE OUTLINE DIMENSIONS**

7 2

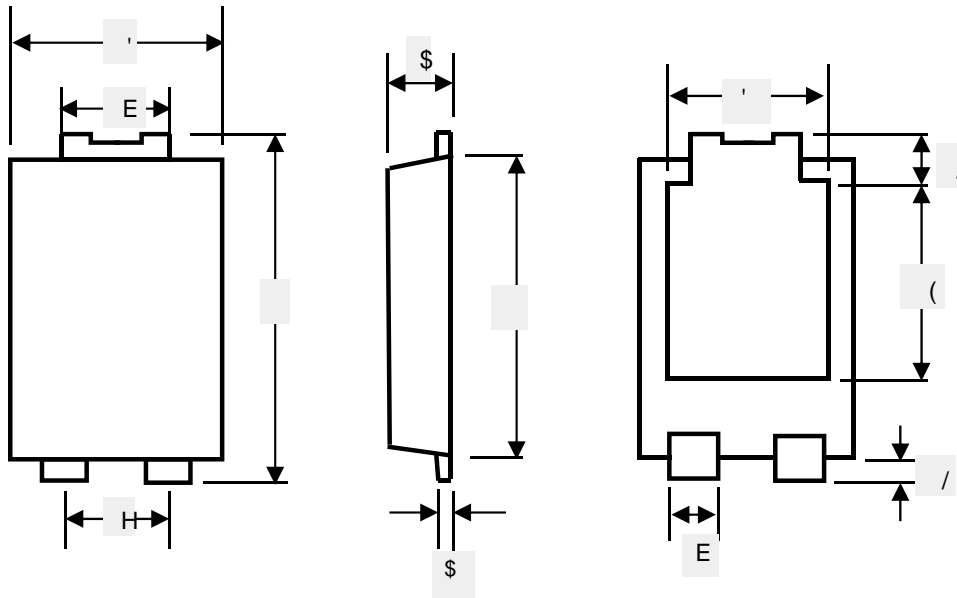

**TO-277 mechanical data**

8 1 , 7		\$	\$	E	E	'	'	(	(	(	/	/
P P	P D [											
	P L Q											
P L O	P D [											
	P L Q											

**7 2 Suggested Pad Layout**

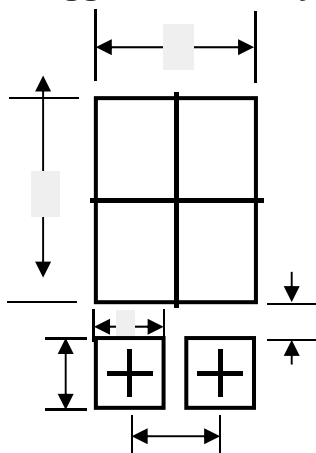

8 1 , 7		&	*	;	;		
P P	P L Q						
P L O	P L Q						

**Marking Information**

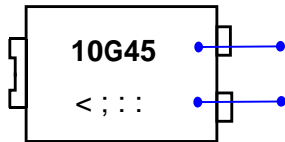

3URGXFW PRGHO 76310U45SPG  
WR DU4510

3' & LQIRUPDWLRQ

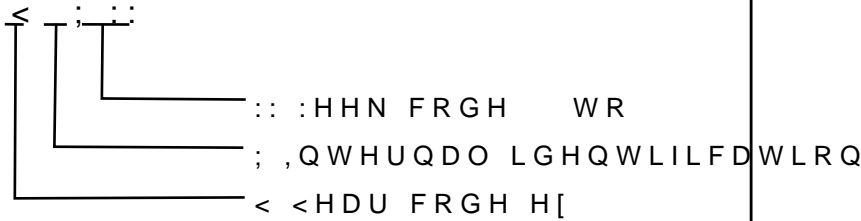

**Packaging Information**

5HHO 'LPHQVLRQV

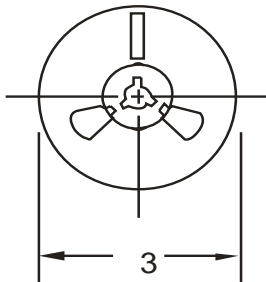

,QVLGH %R[

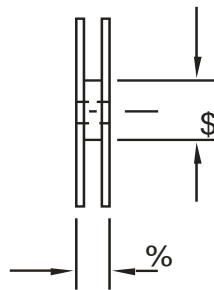

2XWVLGH %R[

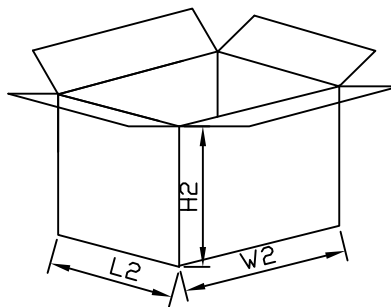
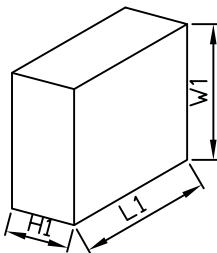

**Packaging Information**

12	81,7	5HHO'PHQVLRQV	,QVLGH	2XWVLGH %R[
		\$	%	/ : +
6L]H	PP			
47<	3&6	6PDOOHVW SDFNDJH	3&6 UHHO	3&6 UHHO
1RWH		7ROHUDQFPP" PP	PP" PP	PP" PP