

\* % 8 (

\* % 8 (

0\$5

6SHFLDO )RU '& \$& 5HFWLILHU %ULG

)HDWXUHV

‡&RPSOLDQW ZLWK 5R+6 3URYLVL  
‡/RZ IRUZDUG YROWDJH KLJK IRU  
‡+LJK IRUZDUG VXUJH FXUUHQW F  
‡+LJK KHDW FRQGXFWLQJ SHUIRU  
‡ 7KHUPDO ZHOGLQJ SHUIRUPDQF  
¥ VHF

3,11,1\*

3,1	'(6&5,37,21
	Input Pinÿ -ÿ
	Input Pinÿ -ÿ
	Output\$QRGHÿ +ÿ
	Output&DWKRGHÿ -ÿ

\$SSOLFDWLRQV

‡6ZLWFKLQJ 3RZHU 6XSSO\  
‡+RPH\$SSOLDQFHV 2IILFH 'HYLFH  
‡,QG XVWULDO \$XWR HTXLSPHQWV

0 D (1&P(R p ')&(ô%FeXQô% IDO@ ' @ .B' @D)A# dLd• E! O			

\*%8 ( ?\*%8 ( 5HY

:RUOG ,QW&KQDMLPRWDG

\* % 8 (

\* % 8 (

0 \$ 5

\$

V

Q

H

U

&

X

U

D

G

R

Z

D

J

H

,

\$

Y

H

,

O

A

2

1

A

1

O

A

7

F

&

D

V

H

R

&

7

H

P

S

7

H

P

S

7

H

P

S

7

H

P

S

7

H

P

S

7

H

P

S

7

H

P

5 \$ 7 , 1 \* 6 \$ 1 ' & + \$ 5 \$ & 7 ( 5 , 6 7 , & 6 & 7 8 5 9 ( 6 f & X Q O H V Q R W K B U Z L V H

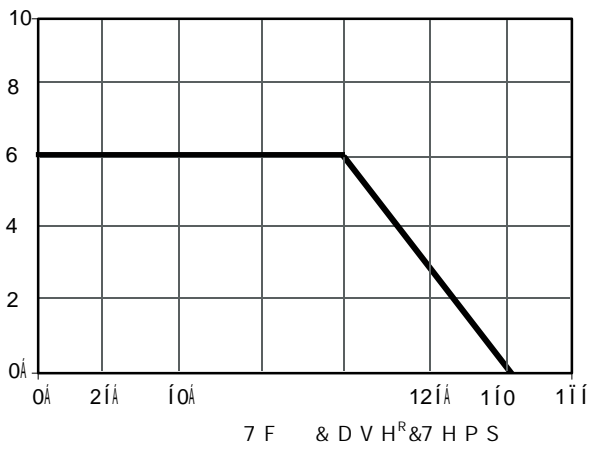

Current Derating, Case

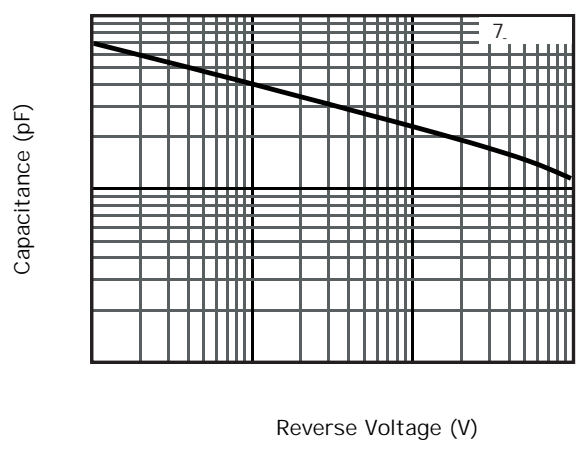

Typical Junction Capacitance

,

I

Q

V

W

R

O

Z

U

H

U

\$

Q

W

R

O

Z

U

H

U

\$

Q

W

R

O

Z

U

H

U

\$

Q

W

R

O

Z

U

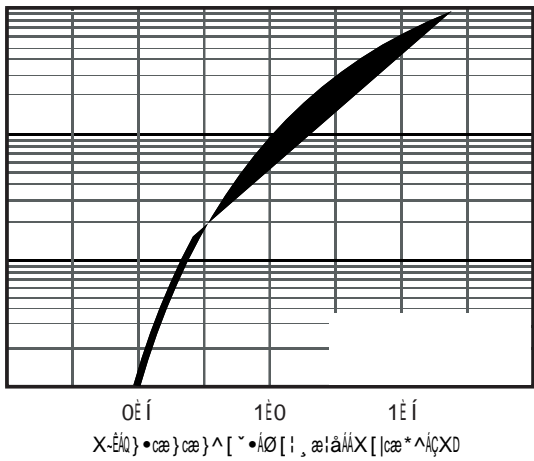

Typical Forward Voltage

9 5 5 H 9 R W H D J H 9 R O W V

Typical Reverse Current

\* % 8 ( ? \* % 8 ( 5 H Y

: R U O G , Q W H & J K L M N O P Q R S T U V W X Y Z

\* % 8 (

\* % 8 (

0\$5

3\$&.\$ ( 287/,1',0(16,216

1RWH XQLW PP LQFK

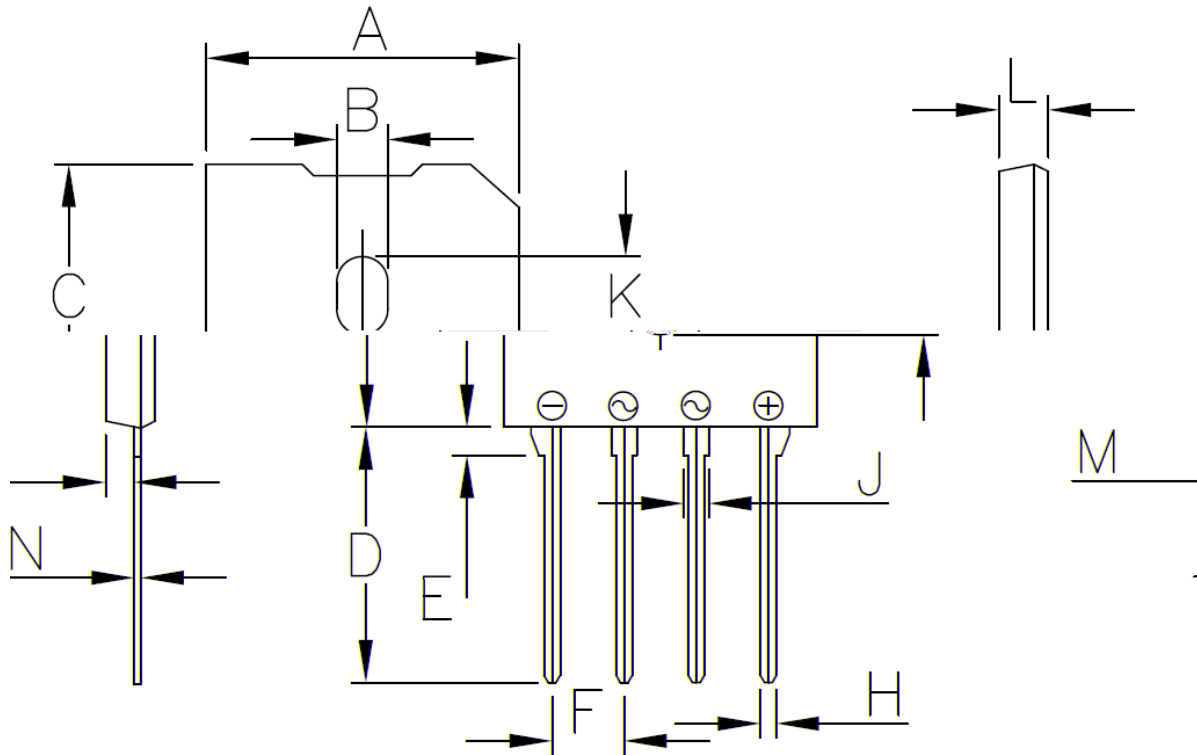

\* % 8 P H F K D Q L F W D X Q L W P P L Q F K

8QLW	\$	%	&	'	( )	+	-	.	/	0	1
PP	PD										
	PLQ										
LQFK	PD										
	PLQ										

\* % 8 ( ? \* % 8 ( 5HY

:RUOG ,QWH&KLDQMLRLO/DHG